



April Commission Report

Director's Update

Given by Rebecca Hupp, Airport Director

APRIL 1, 2026

March Runway Closures



March 4

- **RWY 10R/28L** closed from 8a.m.- 4:30p.m. for maintenance.

March 7

- **RWY 10R/28L** closed from noon - 3p.m. for maintenance

March 9 – March 31

- **RWY 10L/28R** closed for reconstruction. It will reopen from November-March when reconstruction pauses for winter.

Runway 10L-28R Reconstruction



- Project is reconstructing the runway, along with Taxiways Mike and Papa. Taxiway Charlie will be decommissioned.
 - Project began March 9th and will continue throughout the 2026 construction season.
 - Nov. 2026-March 2027: Fully operational (construction shut down for winter)
- Currently averaging between 175-200 semi-trucks worth of asphalt and excavated materials removed from the airfield each day.

Concourse A Apron – Phase 2

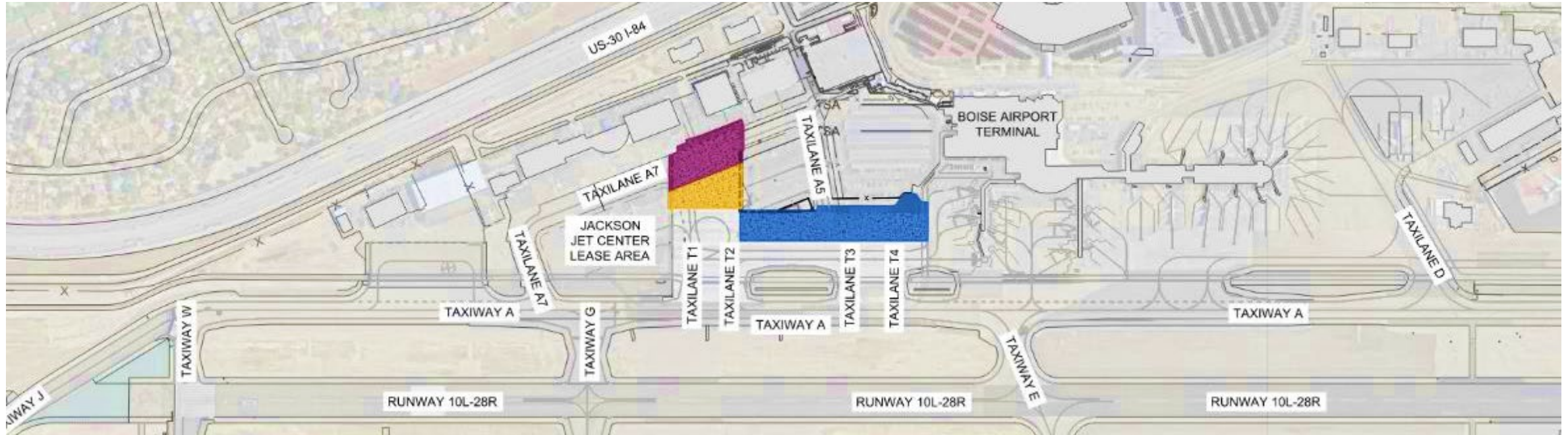

- Project will construct the second phase of the Concourse A Apron
- Bids opened on March 18th – the apparent low bidder is Idaho Materials & Construction
- Anticipated construction duration: May - October 2026

Consolidated Rent-A-Car Center (ConRAC)



- Work along the south and east of the site continues, including:
 - Plaza
 - Sidewalks
 - Landscape/irrigation
- Rental car tenant improvements have begun.
- Terminal connector will be complete in early-April.

Airline Fuel Farm

- Phase 1 – Tank Farm
 - Beginning work on Tank 3. Tank sheets are moved into place with a crane and then welded.
 - One layer is completed at a time before continuing vertically.
- Phase 2 – Truck Platform and Transmission Line
 - Anticipated notice to proceed will be issued in Q2
- Project is paid for by a consortium of airlines, including Alaska, American, Delta, FedEx, Southwest and United
- Expected completion in Spring 2027



Master Plan Update

This month's areas of focus include:

- **Forecast:** FAA approval pending
- **Facility Inventory:** Reviewing draft chapter, tenant meetings ongoing
- **Landside Alternatives:** Draft alternatives to be produced
- **Terminal/Airfield:** Reviewing terminal concepts, airfield evaluation next
- **CRDC/Support Areas:** CRDC report underway, support planning to follow
- **Planning Tasks:** Land analysis and deice operations review starting
- **Environmental/Admin:** Sustainability, mapping (mid-April), SRA and ongoing coordination

The Master Plan will guide airside and landside facility development for the next 20 years.



Master Plan information and schedule are available on the airport's website: <https://www.iflyboise.com/about-boi/masterplan/>

RIM Draft Environmental Assessment

A draft Environmental Assessment for the Runway Incursion Mitigation Program and related improvements to the airfield is now available for public review on the project's website.

<https://www.iflyboise.com/business/10r-ea/>

- Changes under consideration:
 - Extending Runway 28L by 1,578 feet for a total new runway length of 10,000 feet.
 - Relocating and/or replacing navigational aids.
 - Removing portions of Taxiways J and F.
 - Constructing Taxiways B and P.
- A public meeting will be held on April 28th from 5-7 p.m. in the airport's Boise River Room



Spring Break Recap

- BOI enjoyed yet another busy spring break, welcoming approximately 165,000 passengers in the terminal
- Mornings at the checkpoint were busy, with passengers encountering much longer wait times than typical for Boise.
- **This was not due to TSA staffing**—lanes were open and fully staffed—this was due to the sheer number of passengers!
- Parking facilities were able to accommodate demand.



TSA Donation Drive



Local residents and the business community have stepped up again to help TSA employees at BOI!

- Boise Metro Chamber, Tango's Empanadas and a local resident provided lunch.
- The Idaho Foodbank brought a truckload of food, including fruits and vegetables
- KBOI 2 News donated hundreds of dollars worth of items.
- And many, many others!

Huge thanks to our Ops Team for taking the lead on keeping the food pantry table stocked!

BOI 100 Kick-Off!

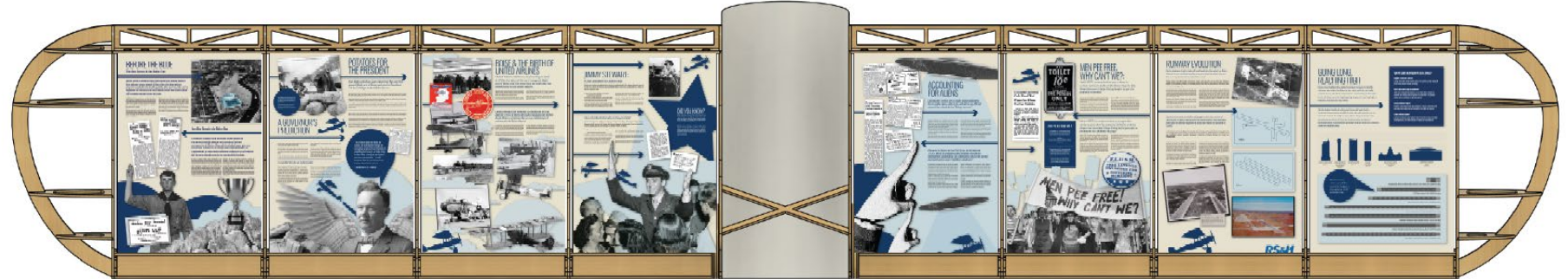

- Monday, April 6th at 11 a.m. historical exhibit ribbon cutting, French café and airmail postcard printing press.
 - *Contact Jennifer if you'd like to attend!*
- First Thursday, May 7th from 5-7 p.m. at Cherie Buckner-Webb Park.
- Family Day on the Airfield, Saturday, June 6th at the old Simplot Hangar.
- Additional details to come!

Congratulations, Bryan!



- Facilities Maintenance Manager Bryan Hill is changing departments!
- Starting April 6th, Bryan will join the Engineering Team as a Landside Senior Project Manager. Bryan will lead development of the new Baggage Handling Building and System.
- He looks forward to delivering a solid system built to keep up with future growth and enhanced passenger experience.
- Bryan is a Boise native and has been with the airport for 12 years.

February Enplanements

Enplanements are up nearly 6% from February 2025.

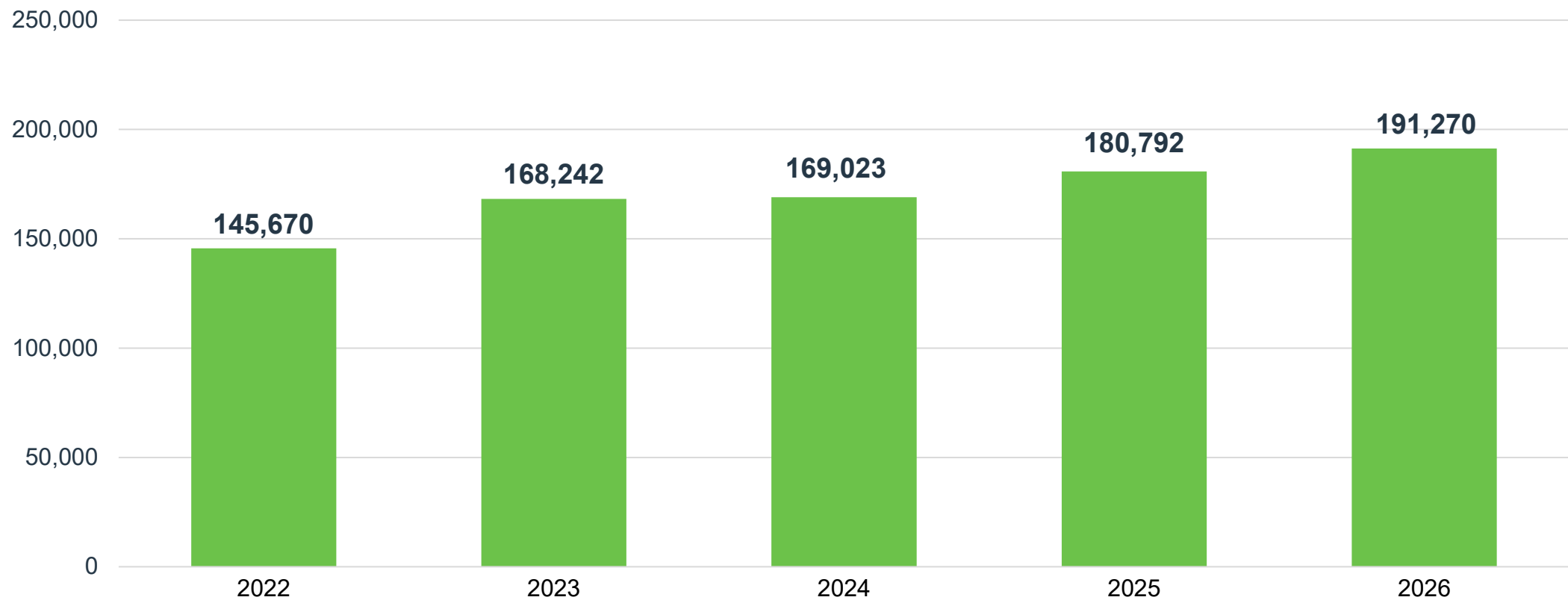

2026 Total Passengers

Nearly 3% increase over February 2025.

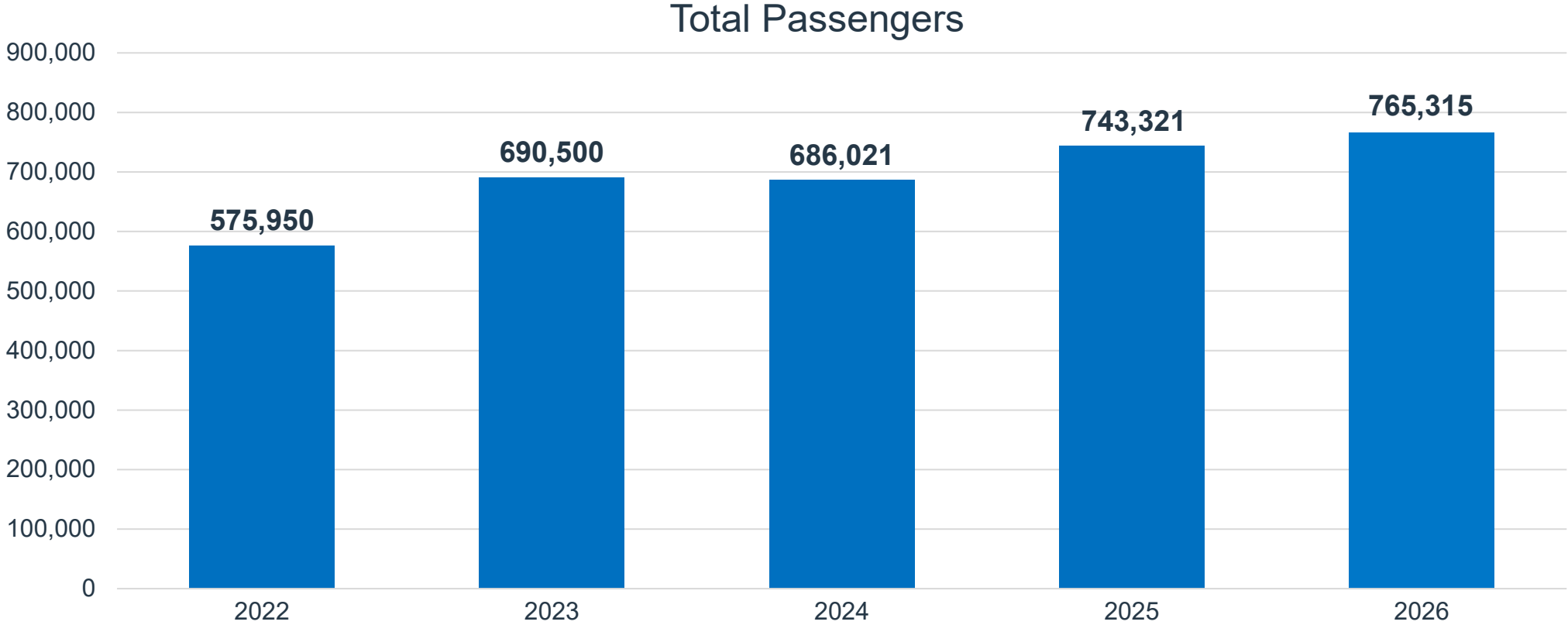

FEBRUARY 2026

Top 10 Operating Revenue Description	FY 2026	FY 2025	\$ Change	% Change
Parking Lot	\$ 10,526,457	\$ 9,253,513	\$ 1,272,944	14%
Signatory Airline Landing Fees	\$ 5,033,427	\$ 5,553,375	\$ (519,948)	-9%
Rental Car Concession	\$ 2,911,065	\$ 2,591,992	\$ 319,073	12%
Terminal Rent - Airlines	\$ 2,887,519	\$ 2,447,487	\$ 440,032	18%
Industrial Land Rent	\$ 1,911,430	\$ 1,804,678	\$ 106,752	6%
Terminal Concessions – Food/Beverage	\$ 971,954	\$ 807,140	\$ 164,814	20%
Rideshare (TNC) Revenue	\$ 768,128	\$ 533,264	\$ 234,865	44%
Terminal Concessions – Retail	\$ 646,399	\$ 474,833	\$ 171,566	36%
Landings/Freight	\$ 594,697	\$ 771,456	\$ (176,758)	-23%
Advertising	\$ 394,812	\$ 392,710	\$ 2,101	1%
Total Top 10 Operating Revenue	\$ 26,645,887	\$ 24,630,446	\$ 2,015,441	--
Other Operating Revenue	\$ 1,902,750	\$ 1,753,663	\$ 149,087	9%
Total Operating Revenue	\$ 28,548,637	\$ 26,384,109	\$ 2,164,528	8%

FEBRUARY 2026

Top 10 Operating Expense Description	FY 2025	FY 2024	\$ Change	% Change
Personnel	\$ 8,091,944	\$ 7,431,411	\$ 660,533	9%
Indirect Cost Reimbursement	\$ 2,592,462	\$ 2,595,039	\$ (2,577)	0%
Fire Service	\$ 2,044,040	\$ 1,980,339	\$ 63,701	3%
Policing Service	\$ 2,030,155	\$ 1,978,863	\$ 51,292	3%
Parking Management	\$ 1,397,415	\$ 1,167,997	\$ 229,418	20%
R/M – Structural/Electrical/Plumbing	\$ 731,269	\$ 688,114	\$ 43,155	6%
Professional Services	\$ 627,260	\$ 910,674	\$ (283,414)	-31%
Power	\$ 565,034	\$ 401,519	\$ 163,515	41%
Software and Cloud Services	\$ 393,198	\$ 174,130	\$ 219,068	126%
Credit Card Fees	\$ 290,456	\$ 310,497	\$ (20,041)	-6%
Total Top 10 Operating Expense	\$ 18,763,235	\$ 17,638,584		
Other Operating Expense	\$ 2,646,249	\$ 2,856,393	\$ (210,144)	-7%
Total Operating Expense	\$ 21,409,484	\$ 20,494,977	\$ 914,507	4%



Boise Airport

www.iflyboise.com

2026 Airfield Construction Projects



Given by Markus Green, Air Side Program Manager
April 1, 2026

2026 Construction Season: Overall Phasing

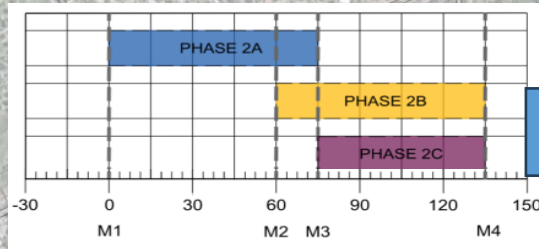

Concourse A Apron – Phase 2

Runway 10L-28R Reconstruction

DAYS	FEB	MAR	APR	MAY	JUN	JUL	AUG	SEP	OCT	NOV
20										
140										
45										
80										
30										
12										
55										
160										

Taxilane S Extension Widening

DAYS	MAY	JUN	JUL	AUG	SEP	OCT
60						
25						
85						

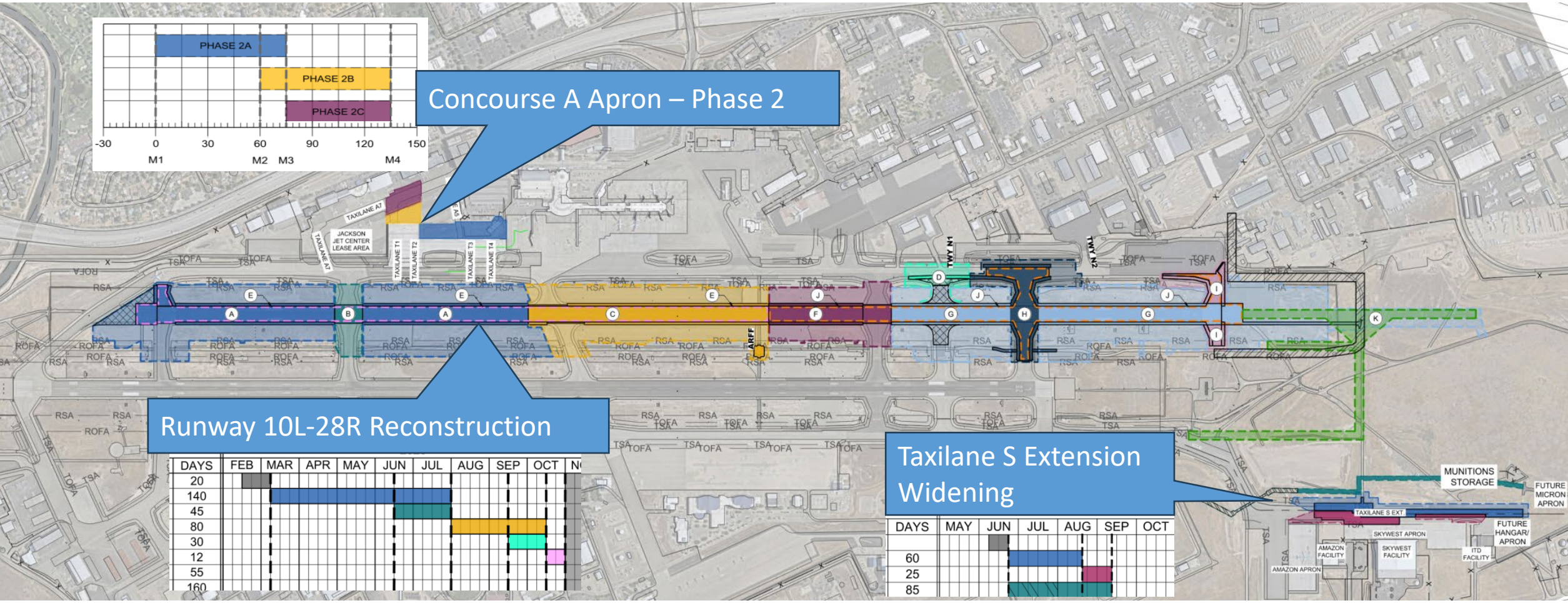

Project 1: Runway 10L-28R

Construction Schedule

The project consists of nine phases over the 2026 and 2027 construction seasons.

- **2026 Construction Season
(232 Calendar Days)**

- Phase 1: 95 Calendar Days
- Phase 2: 45 Calendar Days
- Phase 3: 50 Calendar Days
- Phase 4: 30 Calendar Days
- Phase 5: 12 Calendar Days

- **2026/2027 Winter Shutdown**

- Runway 10L-28R Operational
- Waterline Construction

- **2027 Construction Season
(222 Calendar Days)**

- Phase 6: 55 Calendar Days
- Phase 7: 105 Calendar Days
- Phase 8: 50 Calendar Days
- Phase 9: 12 Calendar Days

Runway 10L-28R: Overall Phasing

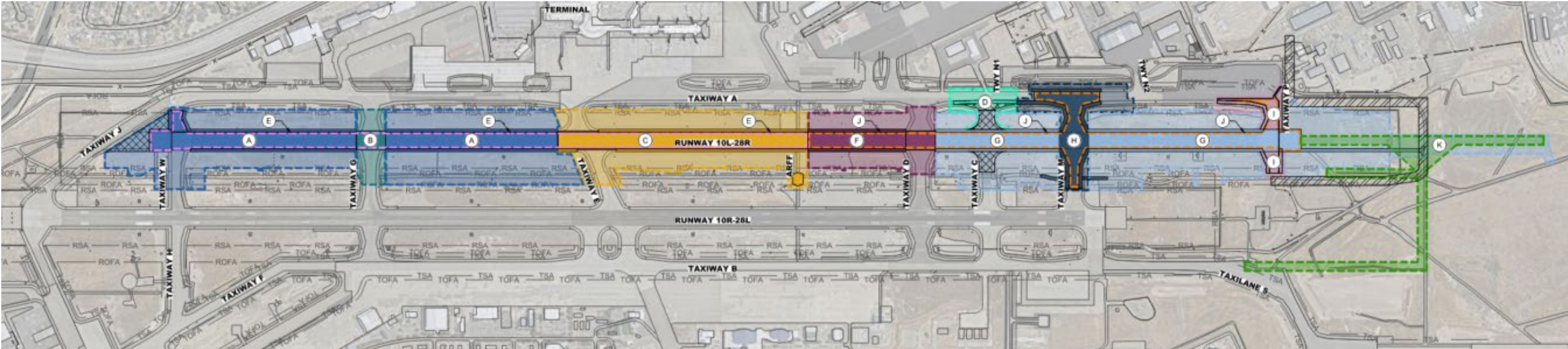

AIRPORT OPERATIONS MILESTONES

1	MARCH 9, 2026	2026 CONSTRUCTION SEASON START - RUNWAY 10L-28R CLOSES, TAXIWAY W CLOSES
2	JUNE 14, 2026	TAXIWAY G CLOSES
3	AUGUST 1, 2026	TAXIWAY W AND G OPEN, TAXIWAY E CLOSES
4	SEPTEMBER 14, 2026	TAXIWAY A CLOSES BETWEEN TAXIWAY D AND TAXIWAY M, TAXIWAY C DECOMMISSIONING
5	OCTOBER 14, 2026	TAXIWAY A AND E OPENS, PAVEMENT COMPLETE, FINAL GROOVING AND MARKINGS
6	NOVEMBER 1, 2026	WINTER SHUTDOWN - RUNWAY 10L-28R OPENS
7	MARCH 8, 2027	2027 CONSTRUCTION SEASON START - RUNWAY 10L-28R CLOSES, TAXIWAY D AND C CLOSES
8	MAY 7, 2027	TAXIWAY D OPENS, TAXIWAY A BETWEEN N1 AND N2 AND TAXIWAY M CLOSES
9	AUGUST 21, 2027	TAXIWAY A AND M OPEN, TAXIWAY P CLOSES
10	OCTOBER 14, 2027	TAXIWAY P OPENS, PAVEMENT COMPLETE, FINAL GROOVING AND MARKINGS
11	NOVEMBER 1, 2027	PROJECT COMPLETE - RUNWAY 10L-28R OPENS

PHASING SEQUENCE

TASK	DAYS	2026												2027								
		FEB	MAR	APR	MAY	JUN	JUL	AUG	SEP	OCT	NOV	DEC	JAN	FEB	MAR	APR	MAY	JUN	JUL	AUG	SEP	OCT
ADMIN	20																					
WORK AREAS																						
A	140																					
B	45																					
C	80																					
D	30																					
E	12																					
F	55																					
G	160																					
H	110																					
I	50																					
J	12																					
K	215																					
FAA																						
FC1	2																					
FC2	2																					
IP																						
IP1	160																					
MILESTONES:			1			2		3		4		5		6								
PHASES:				P1			P2		P3		P4		P5	WINTER SHUTDOWN			P6		P7		P8	P9

Runway 10L-28R: Phase 2 (2026)

45 Calendar Days

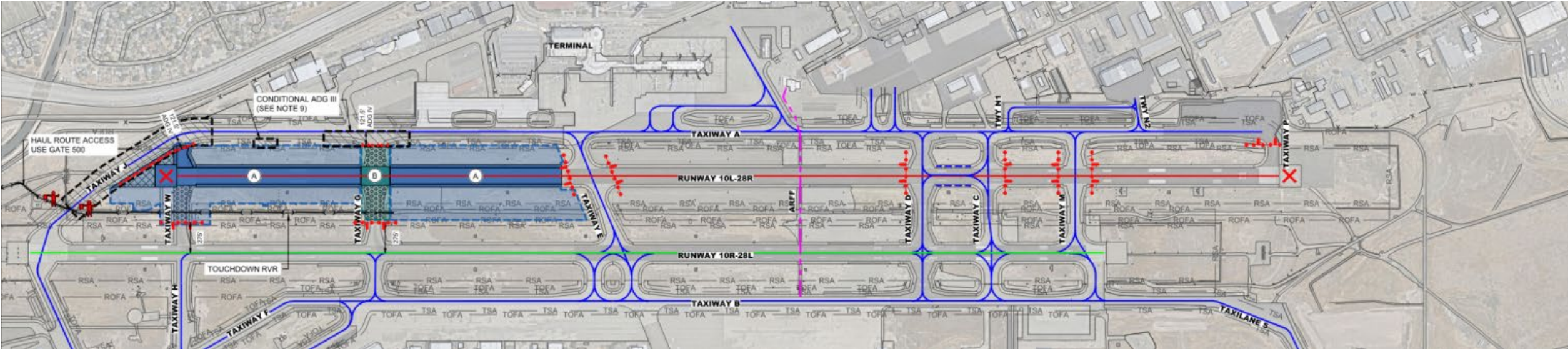

Operational Impacts:

- Runway 10L–28R: Closed
- Taxiway A: Open (Conditional limited operations)
- Taxiway J: Open (Conditional limited operations)
- Taxiway W: Closed
- Taxiway G: Closed between Runway 10L–28R and TW A

		2026												
TASK	DAYS	FEB	MAR	APR	MAY	JUN	JUL	AUG	SEP	OCT	NOV	DEC	JAN	FEB
ADMIN	20	█												
WORK AREAS	A					█	█							
	B					█	█							
	C													
	D													
	E													
	F													
	G													
	H													
	I													
	J													
	K													
IP FAA	FC1													
	FC2													
IP	IP1													
MILESTONES:			1			2	3	4	5	6				
PHASES:				P1		P2	P3	P4	P5					WINTER SHUTDOWN

Runway 10L-28R: Phase 3 (2026)

50 Calendar Days

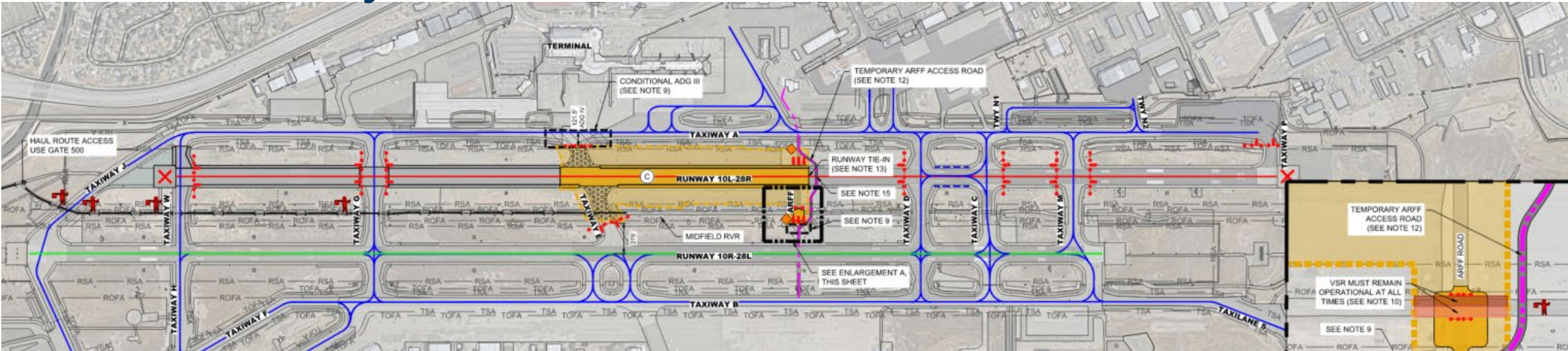

Operational Impacts:

- Runway 10L–28R: Closed
- Taxiway E: Closed North of RW 10R-28L
- ARFF Road: Closed (Use of Temporary ARFF Access Road)

		2026												
TASK	DAYS	FEB	MAR	APR	MAY	JUN	JUL	AUG	SEP	OCT	NOV	DEC	JAN	FEB
ADMIN	20													
WORK AREAS	A	140												
	B	45												
	C	80												
	D	30												
	E	12												
	F	55												
	G	160												
	H	110												
	I	50												
	J	12												
	K	215												
FAA	FC1	2												
	FC2	2												
IP	IP1	160												
MILESTONES:			1			2	3	4	5	6				
PHASES:				P1		P2	P3	P4	P5					WINTER SHUTDOWN

Runway 10L-28R: Phase 5 (2026)

12 Calendar Days

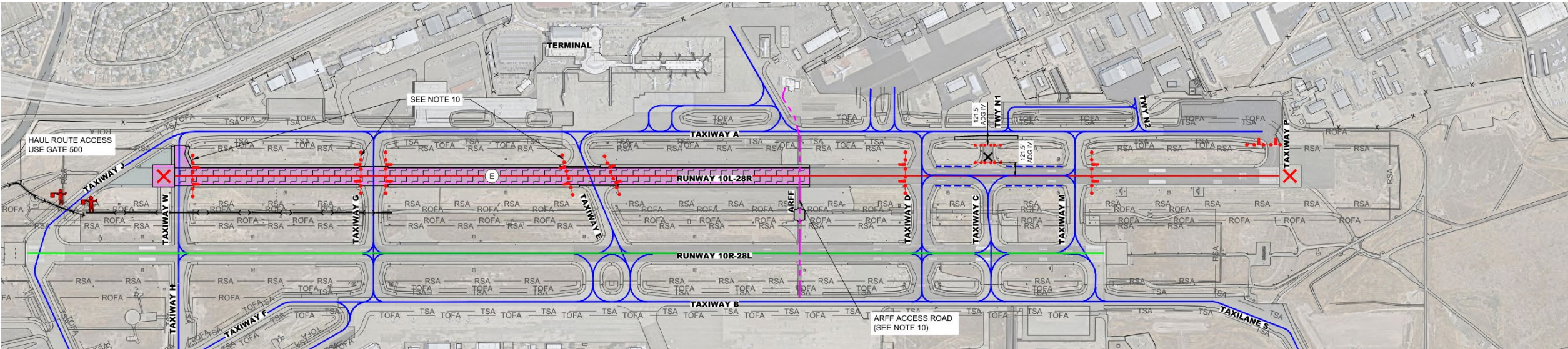

Operational Impacts:

- Runway 10L–28R: Closed
- Taxiway C: Decommissioned (North of RW 10L-28R)
- Taxiway W, G, E: Intermittently closed (only one closed at a time)

		2026												
TASK	DAYS	FEB	MAR	APR	MAY	JUN	JUL	AUG	SEP	OCT	NOV	DEC	JAN	FEB
ADMIN	20													
WORK AREAS	A													
	B													
	C													
	D													
	E													
	F													
	G													
	H													
	I													
	J													
	K													
FAA	FC1													
	FC2													
IP	IP1													
MILESTONES:			1			2	3	4	5	6				
PHASES:				P1		P2	P3	P4	P5					WINTER SHUTDOWN

Project 2: Concourse A Apron Phase 2

Construction Schedule

The project consists of three phases during the 2026 construction season.

- **2026 Construction Season
(135 Calendar Days)**
 - Phase 2A – 75 Calendar Days
 - Phase 2B – 75 Calendar Days
 - Phase 3C – 60 Calendar Days

Concourse A Apron Phase 2: Overall Phasing

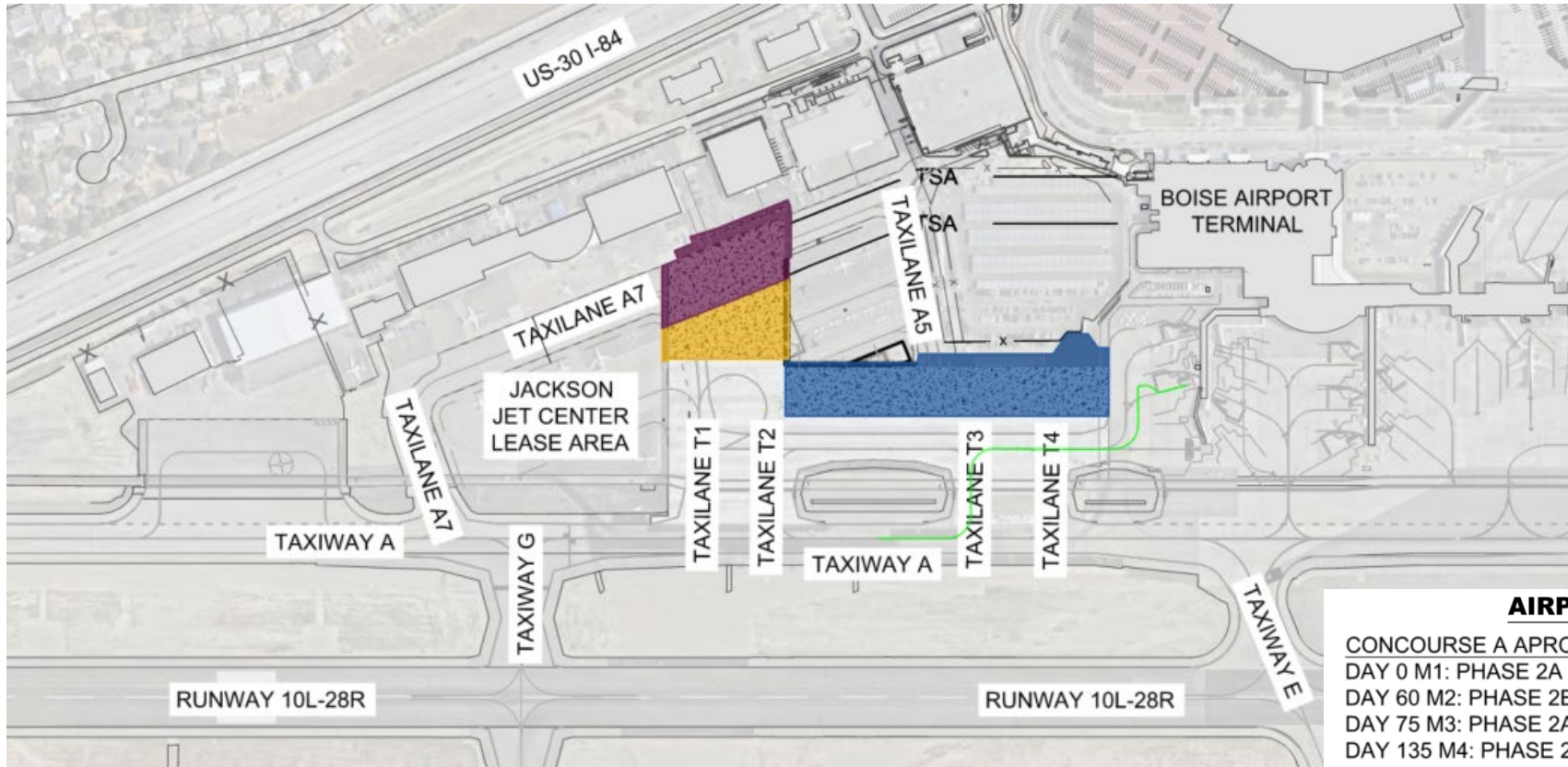

PHASING SEQUENCE

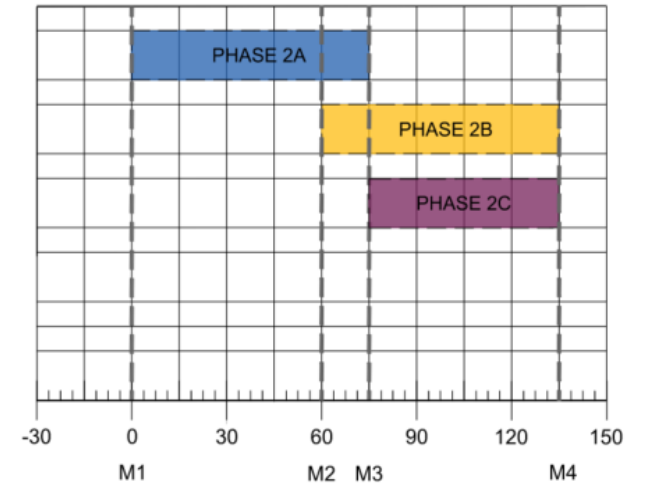

AIRPORT OPERATIONS MILESTONES

CONCOURSE A APRON CONSTRUCTION SEASON (2026 CONSTRUCTION SEASON):
 DAY 0 M1: PHASE 2A BEGINS (2026 CONSTRUCTION)
 DAY 60 M2: PHASE 2B BEGINS
 DAY 75 M3: PHASE 2A COMPLETE, PHASE 2C BEGINS
 DAY 135 M4: PHASE 2B AND PHASE 2C COMPLETED

Concourse A Apron Phase 2A:

75 Calendar Days

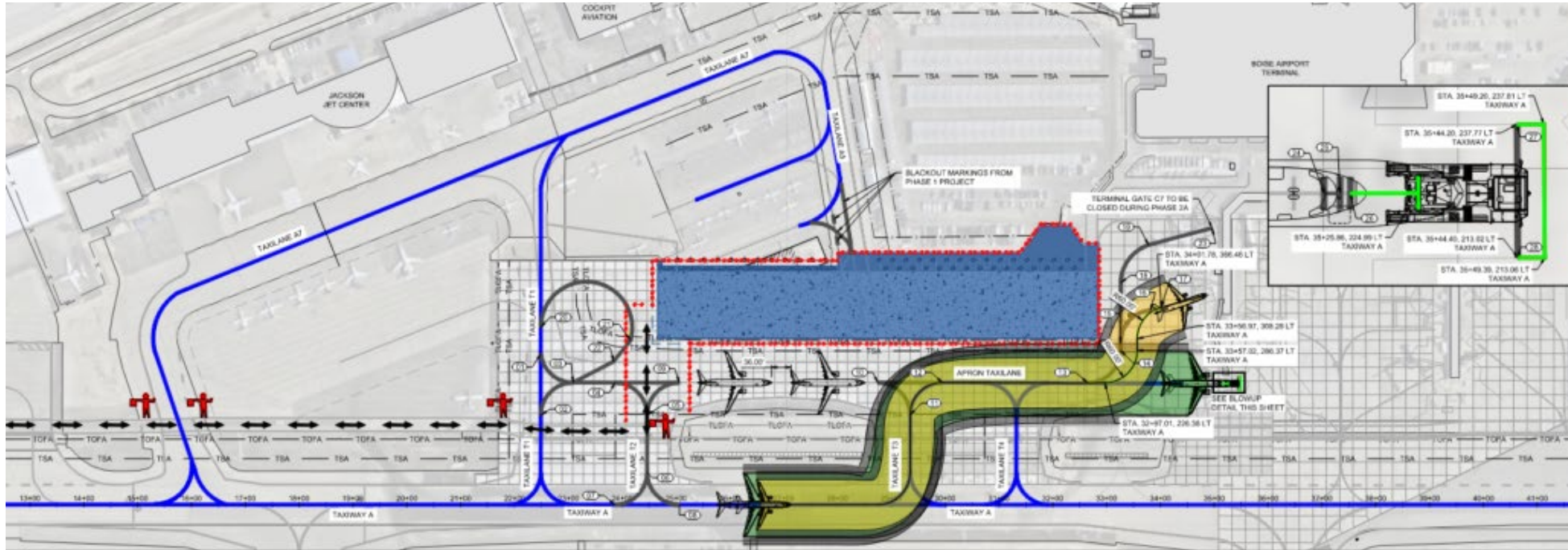

PHASING SEQUENCE

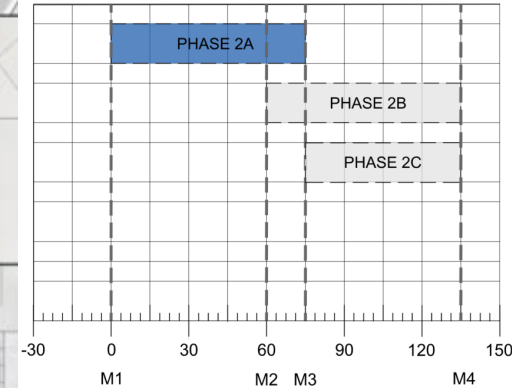

Operational Impacts:

- Taxiway T2: Closed
- Apron Taxiway T2-T3: Partially Closed (RON)

Concourse A Apron Phase 2B:

75 Calendar Days

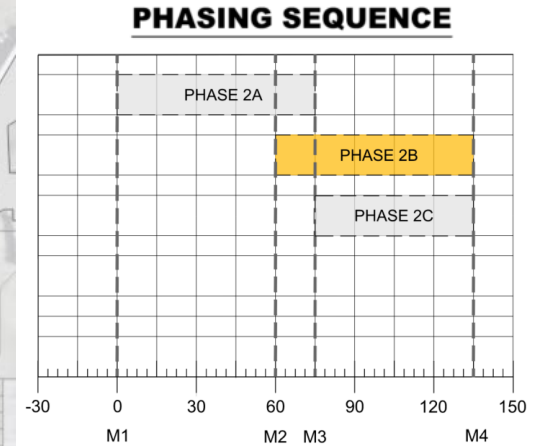
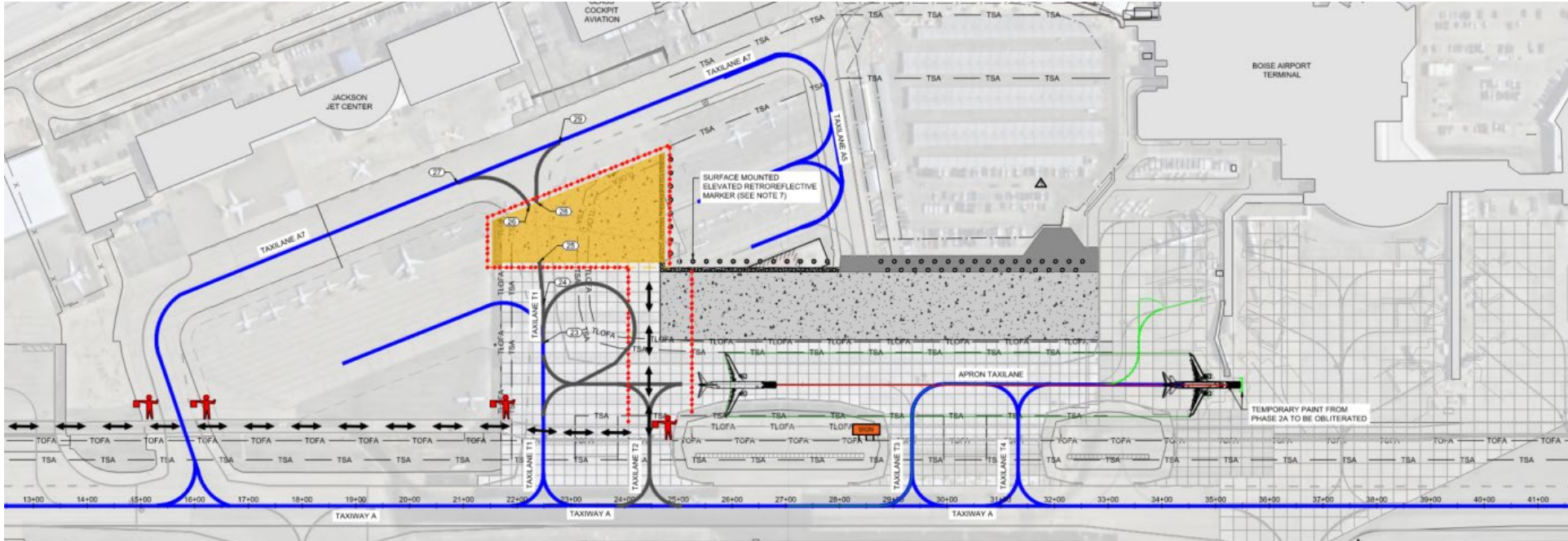

Operational Impacts:

- Taxiway T1 to North Taxiway: Closed
- Taxiway T2 to Apron Taxiway: Closed
- Apron Taxiway T2-T3: Partially Closed (RON)

Concourse A Apron Phase 2C:

60 Calendar Days

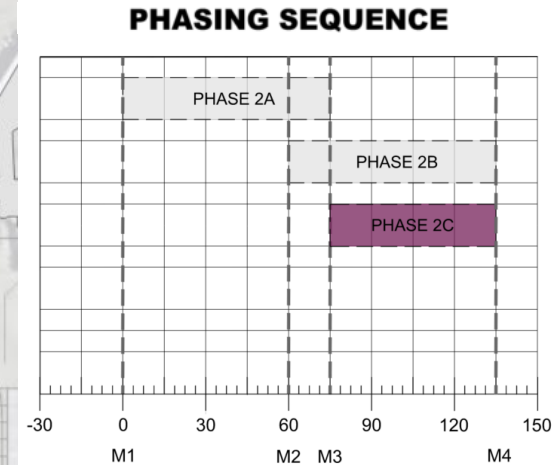
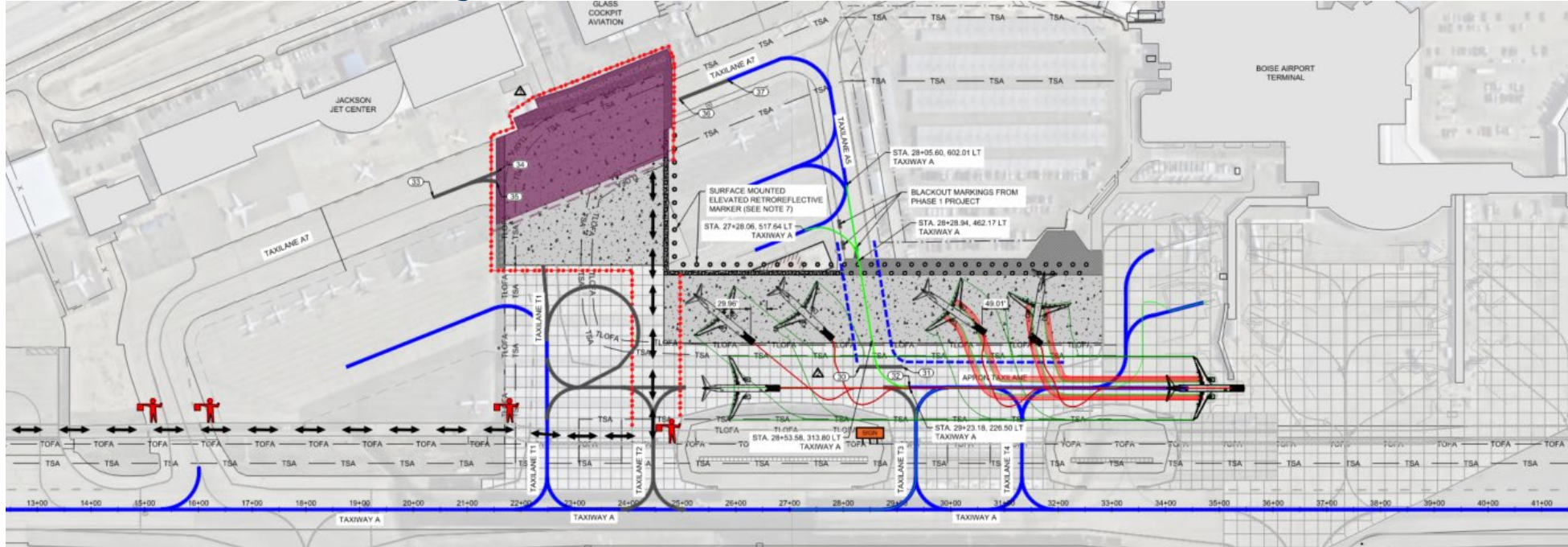

Operational Impacts:

- Taxiway T1 to North Taxiway: Closed
- North Taxiway: Closed
- Taxiway T2: Closed
- Apron Taxiway T2-T3: Closed

Project 3: Taxilane S Extension Widening

Construction Schedule

The project consists of two phases during the 2026 construction season.

- **2026 Construction Season (85 Calendar Days)**
 - Phase 1 – 60 Calendar Days
 - Phase 2 – 25 Calendar Days

Taxilane S Extension Widening: Overall Phasing

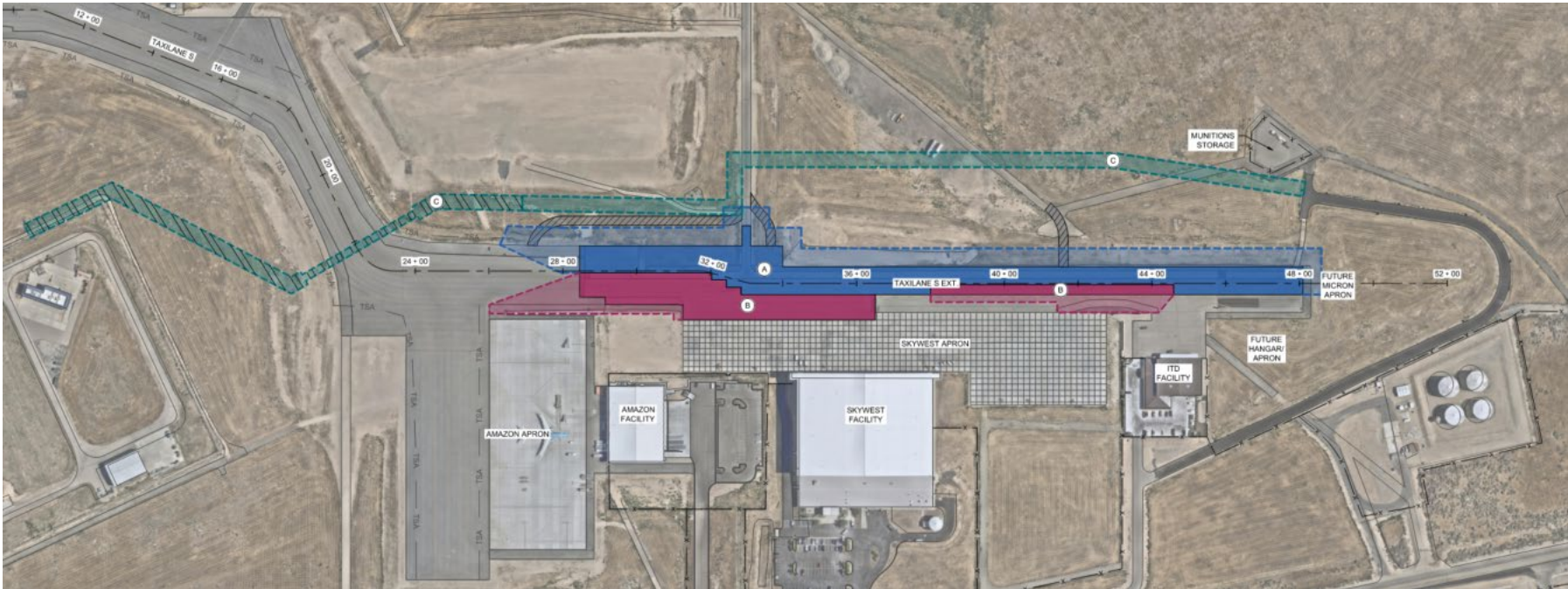

AIRPORT OPERATIONS MILESTONES

1	JUNE 22, 2026	2026 CONSTRUCTION SEASON START - TAXILANE S SHIFTED CENTERLINE TO SOUTH AND REDUCED ADG TDG AIRCRAFTS
2	AUGUST 21, 2026	NEW TAXILANE S SHIFTED CENTERLINE TO NORTH
3	SEPTEMBER 15, 2026	PROJECT COMPLETE - TAXILANE S OPEN NO RESTRICTIONS

PHASING SEQUENCE

		2026							
		MAY	JUN	JUL	AUG	SEP	OCT	NOV	DEC
AREAS	ADMIN								
	A								
	B								
	C								
MILESTONES:			1			2		3	
PHASES:				P1		P2			

Taxilane S Extension Widening – Phase 1: 60 Calendar Days

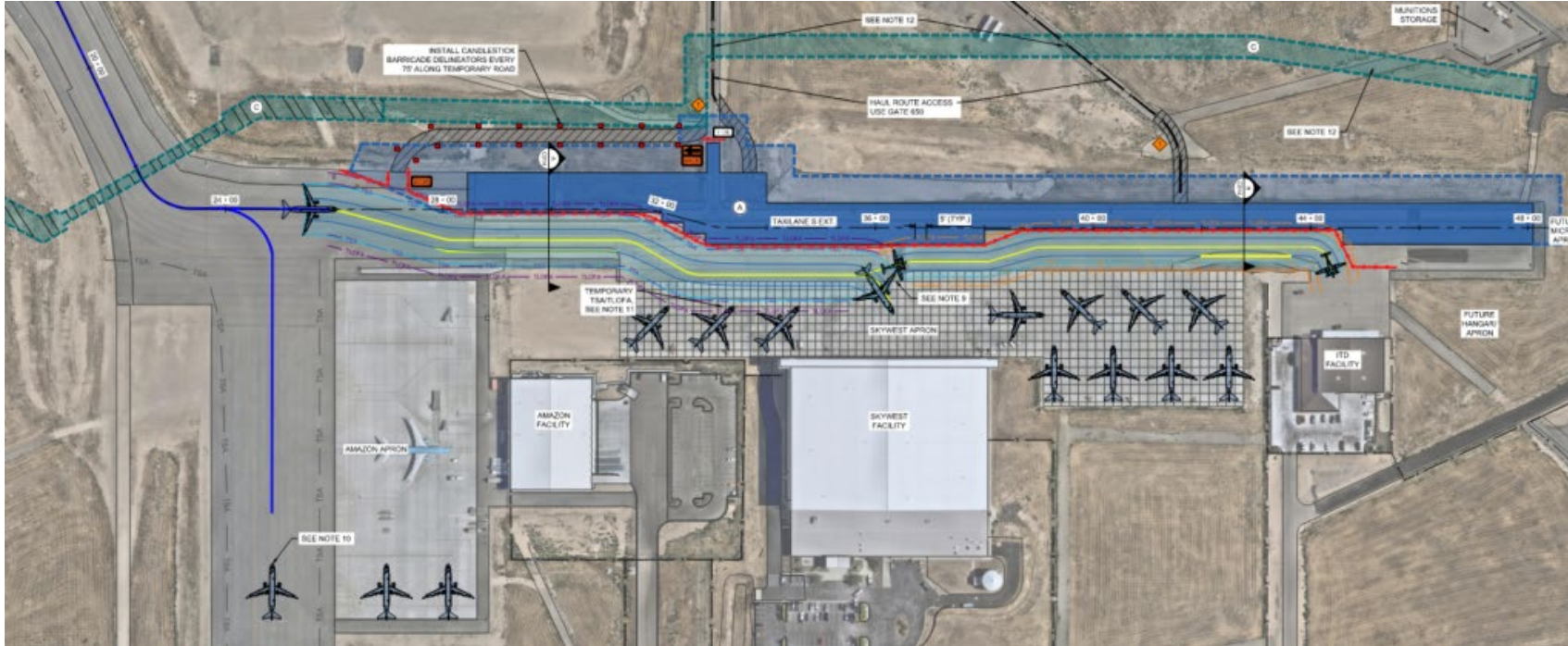

Operational Impacts:

- Taxilane S Extension:
 - ADG II (King Air 350) East of SkyWest Hangar
 - Temporary shifted Centerlines

PHASING SEQUENCE

		2026									
TASK	DAYS	MAY	JUN	JUL	AUG	SEP	OCT	NOV	DEC		
ADMIN			■								
AREAS	A	60		■	■	■					
	B	25				■					
	C	85		■	■	■	■				
MILESTONES:				1		2	3				
PHASES:					P1	P2					

Taxilane S Extension Widening – Phase 2: 25 Calendar Days

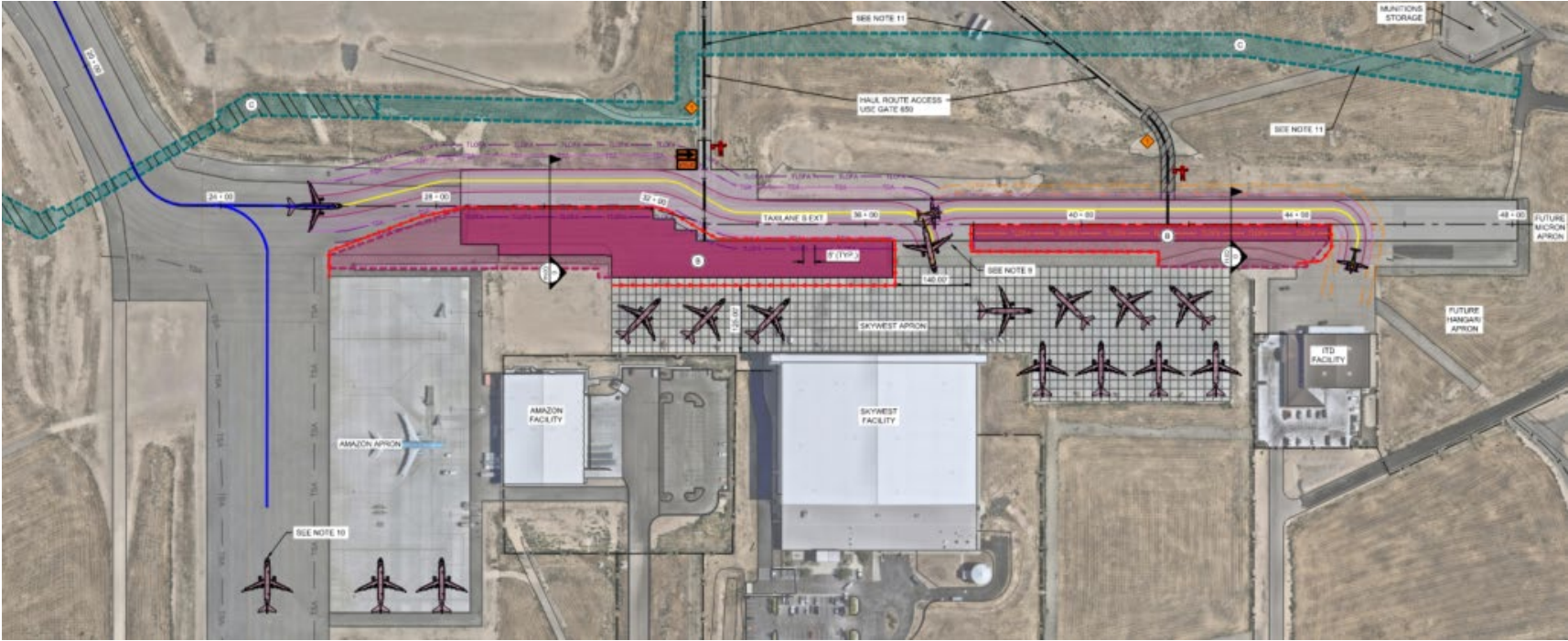

Operational Impacts:

- Taxilane S Extension:
 - ADG II (King Air 350) East of SkyWest Hangar
 - Temporary shifted Centerlines

PHASING SEQUENCE

		2026									
TASK	DAYS	MAY	JUN	JUL	AUG	SEP	OCT	NOV	DEC		
ADMIN			█								
AREAS	A			█	█	█					
	B					█					
	C			█	█	█	█				
MILESTONES:				1		2	3				
PHASES:					P1		P2				

Questions?



Boise Airport

www.iflyboise.com